

Alphington Link

Engagement summary

Information update
June 2022

The Victorian Government is investing \$9.1 million to plan and deliver a direct connection from Alphington to the Darebin Creek Trail – the Alphington Link.

To understand how the Alphington Link will be used and ensure our designs reflect community needs, community consultation took place between 8 December and 31 January 2022.

What we proposed

We proposed to provide a direct link to the Darebin-Yarra Trail via Farm Road via a shared user path suitable for use by bike riders, pedestrians and people who use wheelchairs and mobility aids.

What we heard

Through our information sessions, face-to-face on site visits and written submissions, you told us:

You're supportive and excited about the proposed changes and happy about:

- the confirmed location for the link.
- safe and easy access from Alphington to the Darebin Yarra Trail.
- removing the need to use Heidelberg Road to access the trail.
- the retention of vegetation and minimal environmental impacts.

You have some concerns about:

- how the traffic conditions on Farm Road will be managed to promote safety for cyclists.
- vegetation removal and replanting strategies.

People reached



2,827
visits to the
Vicroads website



28
people attended an
information session



31
feedback submissions
provided



21,320
people reached
through Facebook

- how the link structure will blend into the surrounding environment.
- how parking conditions on Farm Road will be managed in future.

The feedback told us that the community supports the Farm Road link and would like to see it delivered as soon as possible.

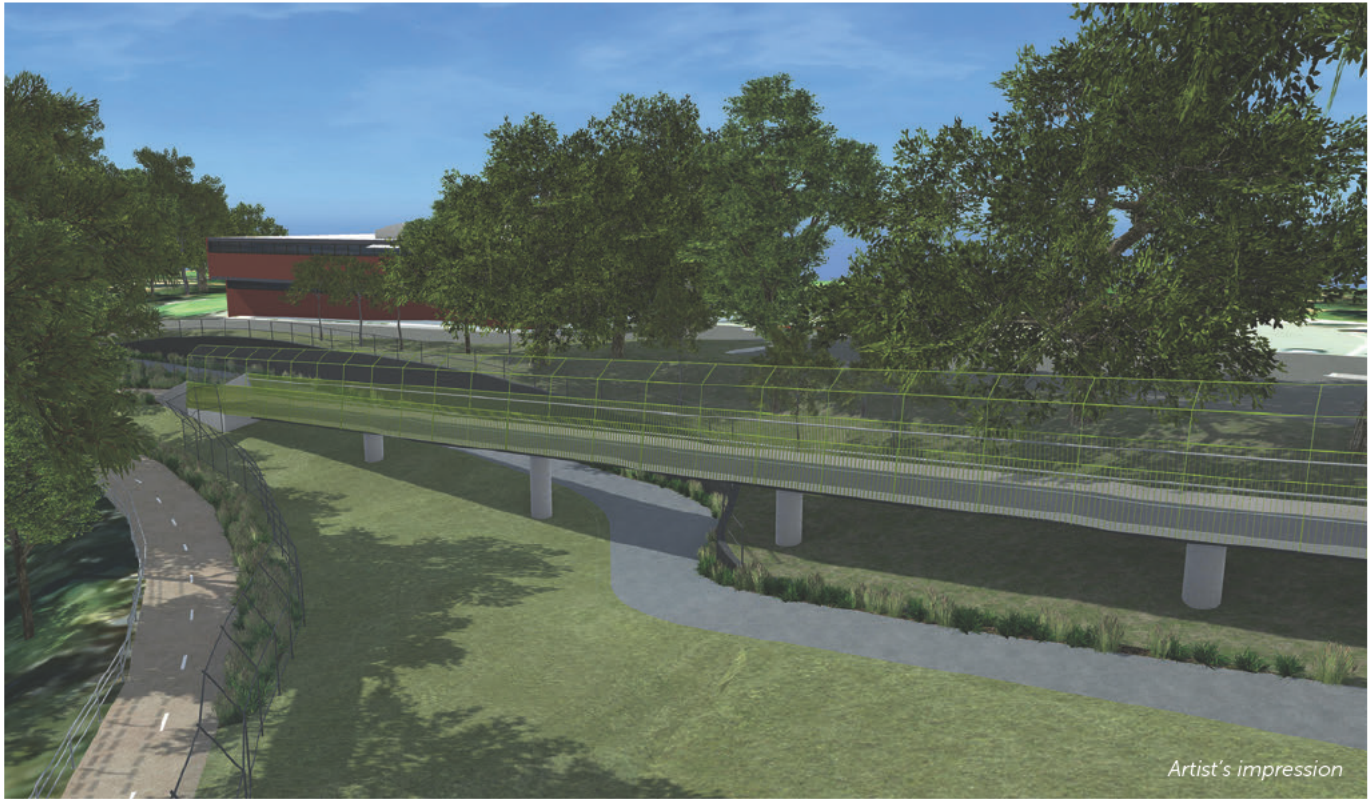

Next steps

We would like to thank everyone who took the time to provide us with feedback and share their ideas for the Alphington Link.

We're continuing to move through the planning process, submitting an application to the Minister for Planning to exercise powers under Section 20(4) of the Planning and Environment Act 1987 to 'fast track' the planning process.

This application was submitted in March 2022, with works on track to commence in 2023.

Feedback is being considered in our updated designs and we will be back later in the year to update you on progress.

You asked:

Q: What is a shared user path?

A: A shared user path is a path designed for use by both pedestrians and cyclists. They are typically between 2.5 and 3.5 metres in width, depending on whether the path is recognised as a local access path, regional path or recreational path.

Q: What are DDA requirements?

A: The Federal Disability Discrimination Act 1992 (DDA) provides protection for everyone in Australia against discrimination based on a disability. Australian Standards state the minimum design requirements for new building work to enable access for people with disabilities.

Q: Why did VicRoads select Farm Road as the preferred alignment?

A: The Farm Road link was selected as the most appropriate option as it presented the most direct route to the Darebin Creek Trail without significant environmental impact to the creek environment or impeding the Darebin Creek floodplain. It is comparatively the shortest and lowest cost option, with other assessed options needing longer structures to be built to comply with DDA requirements.

Q: Why was Old Heidelberg Road not selected?

A: We considered several alignment options including accessing the trail via Old Heidelberg Road. This route was not preferred due to the technical constraints of the location and requirement to make the path accessible for everyone to use, conflict between trail users, pedestrians and vehicles, and as this alignment would have heavily impacted the environment and flood plain.

Find out more

For more information, visit the VicRoads website and search 'Alphington Link'.

Email: DOTroadprojects@roads.vic.gov.au

Visit: vicroads.vic.gov.au