

FRONT VIEW

- 30 RU
- 29 RU
- 28 RU
- 27 RU
- 26 RU
- 25 RU
- 24 RU
- 23 RU
- 22 RU
- 21 RU
- 20 RU
- 19 RU
- 18 RU
- 17 RU
- 16 RU
- 15 RU
- 14 RU
- 13 RU
- 12 RU
- 11 RU
- 10 RU
- 9 RU
- 8 RU
- 7 RU
- 6 RU
- 5 RU
- 4 RU
- 3 RU
- 2 RU
- 1 RU

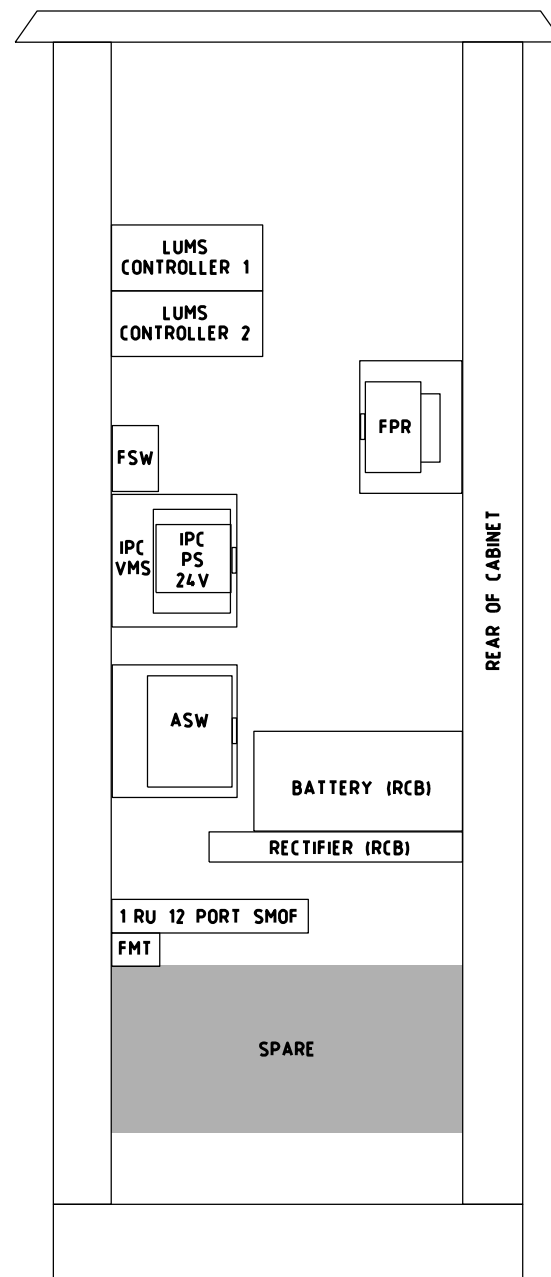

VIEW A
NTS

- 30 RU
- 29 RU
- 28 RU
- 27 RU
- 26 RU
- 25 RU
- 24 RU
- 23 RU
- 22 RU
- 21 RU
- 20 RU
- 19 RU
- 18 RU
- 17 RU
- 16 RU
- 15 RU
- 14 RU
- 13 RU
- 12 RU
- 11 RU
- 10 RU
- 9 RU
- 8 RU
- 7 RU
- 6 RU
- 5 RU
- 4 RU
- 3 RU
- 2 RU
- 1 RU

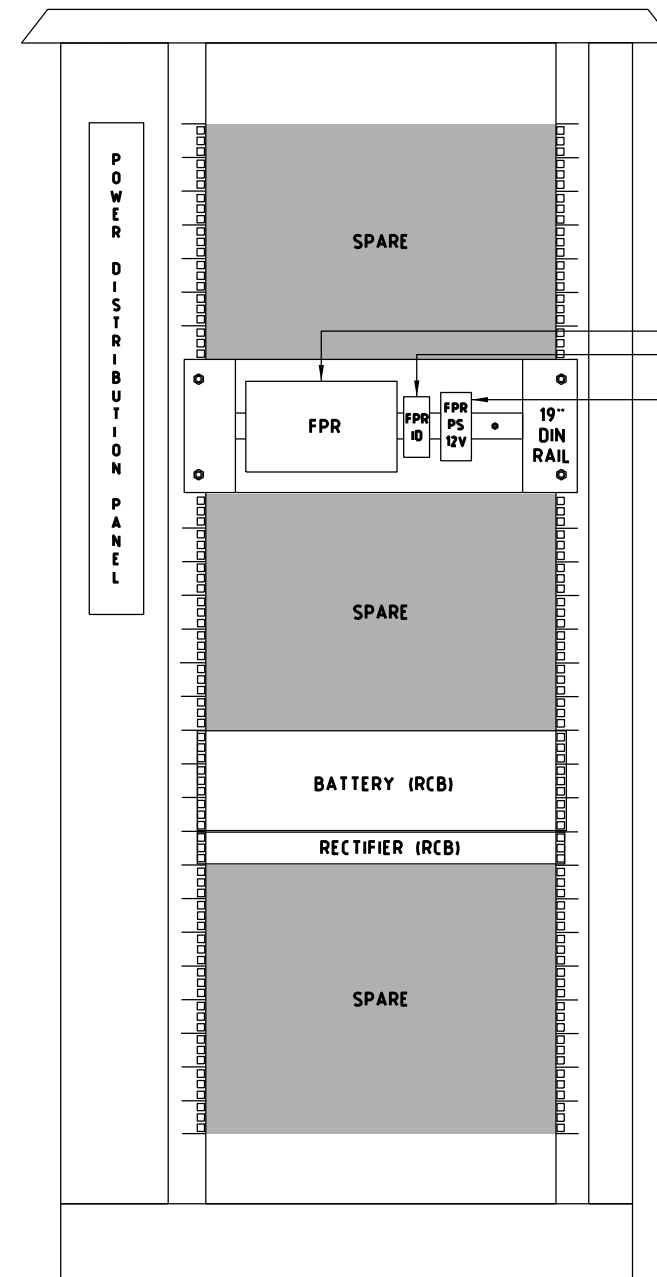

REAR VIEW

FIELD PROCESSOR
FIELD PROCESSOR
ID DONGLE
FIELD PROCESSOR
POWER SUPPLY

LEGEND:

- ASW COMMUNICATION NETWORK ACCESS SWITCH
- SMOF SINGLE MODE OPTIC FIBRE
- RCB ROADSIDE CABINET (ITS FIELD CABINET)

NOTES

- 1 SPARE RUs AT THE BOTTOM OF THE CABINET ARE FOR ACCESS TO CABLE ENTRY
- 2 ALL ITS DEVICES TO BE LABELLED WITH THEIR RELEVANT RAINUMBERS
- 3 WHERE DEVICE SIZE VARIES FROM THAT SHOWN AND ALTERNATIVE CABINET LAYOUT SHALL BE PROVIDED TO BE REVIEWED AND APPROVED BY VICROADS

E			
D			
C			
B			
A	W H	12/2018	REVISION OF DETAIL
ISSUE	APP'D	DATE	AMENDMENT

GENERAL NOTES	
---------------	--

DESIGNED	M80 UPGRADE	07/2015
APPROVED	W HARVEY - MANAGER	
	ITS INFRASTRUCTURE & SYSTEM 08/2015	
CAT:	SCALE OF METRES	
PROJ:	NTS	
FILE:	HOR	VER



STANDARD DRAWING				
MANAGED MOTORWAY				
ELECTRICAL AND COMMUNICATIONS NETWORK				
WIRING ARRANGEMENTS				
TYPICAL ITS FIELD CABINET LAYOUT LUMS & VMS				
FILE NO	CONTRACT NO	SHEET NO	DRAWING NO	ISSUE
			TC-2244	A