

TYPE # 1A

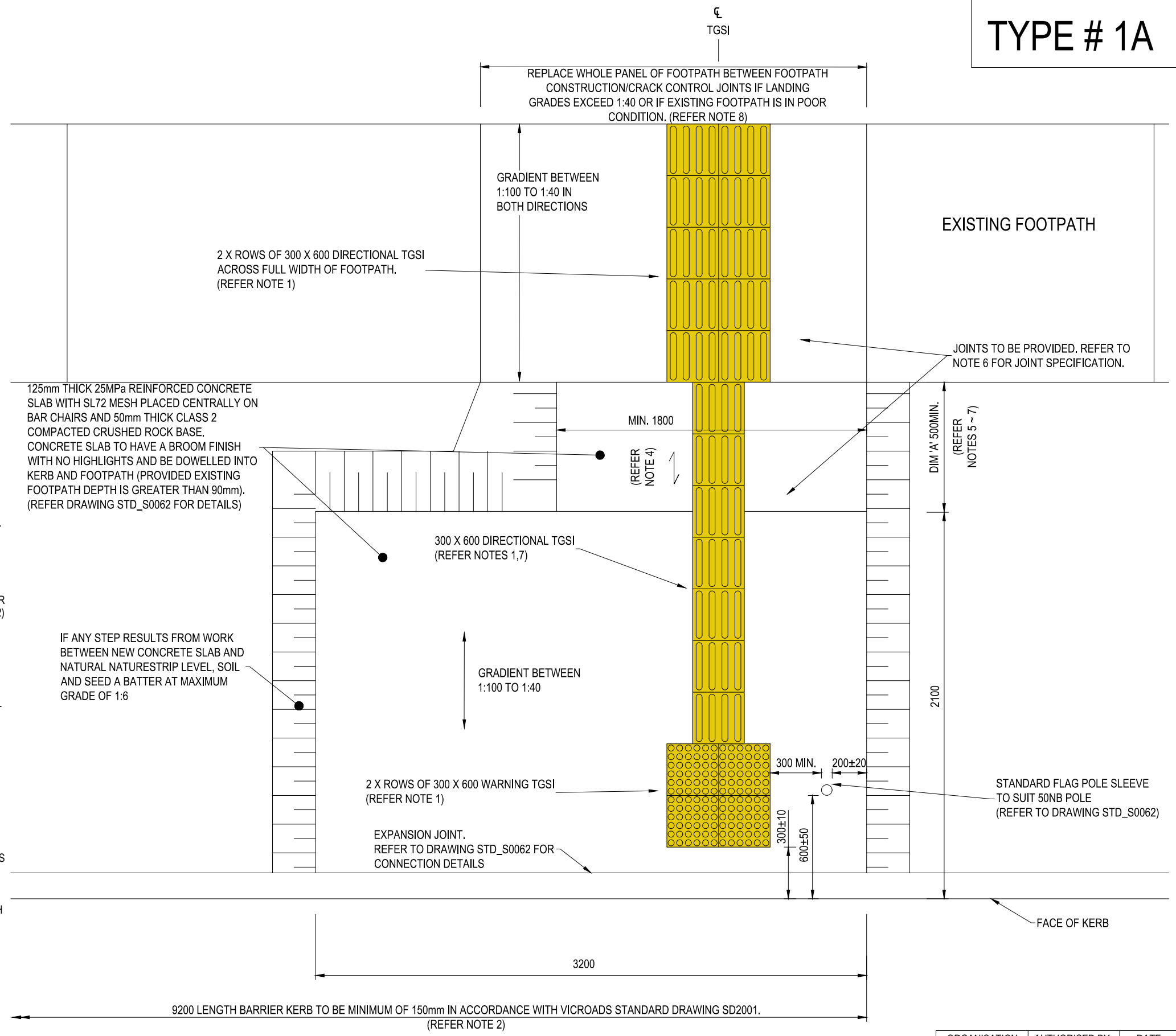

NOTES:

- DOT ONLY ACCEPTS YELLOW TGSIS, MECHANICALLY AND CHEMICALLY SECURED ON ANY STABLE SURFACE, AS PER MANUFACTURES SPECIFICATIONS. TGSIS MUST BE AN APPROVED PRODUCT BY VICROADS AS PER VICROADS DESIGN NOTE RDN06-05.
- RETAIN EXISTING KERB IF KERB IS A BARRIER KERB OF MINIMUM HEIGHT 150MM.
 - IF THE EXISTING KERB IS NOT A BARRIER KERB, REPLACE THE EXISTING KERB WITH A BARRIER KERB MINIMUM 9.2M LENGTH AND A MINIMUM 150MM HIGH (MAX 190MM) FROM KERB INVERT. IF THE EXISTING KERB IS A BARRIER KERB WITH A HEIGHT LESS THAN 150MM FROM THE KERB INVERT, REPLACE THE BARRIER KERB UP TO THE LENGTH OF THE BUS STOP HARDSTAND. KERB INVERT TO BE ALIGNED.
 - WHERE PEDESTRIAN FENCE IS REQUIRED, EXTEND THE HARDSTAND BY 150MM.
 - KERB TRANSITION SHALL BE PROVIDED IN ACCORDANCE WITH VICROADS STANDARD DRAWING SD2102.
 - KERB RETURN SHALL BE PROVIDED IN ACCORDANCE WITH VICROADS STANDARD DRAWING SD2101.
 - IF A DRIVEWAY IS SITUATED WITHIN 9M OF THE BUS STOP FLAG POLE ON APPROACH, THE DRIVEWAY WILL NEED TO REMAIN, SO ANY NEW BARRIER KERB SHALL BE TIED INTO THE EDGE OF DRIVEWAY.
- THE MINIMUM GRADES OF THE CONCRETE INFILL SLAB SHALL BE LIMITED AS FOLLOWS:
 - FOR FURTHER GUIDANCE, PLEASE REFER TO GUIDANCE AND REQUIREMENT TO KEY FEATURES FOR WALKWAYS, RAMPS AND STEP KERB RAMPS TO SATISFY DSAPT (AND AS1428.1-2001 & AS1428.2-1992)
 - IF DIMENSION 'A' IS LESS THAN 1.9m THEN MAXIMUM ALLOWABLE GRADE SHALL BE 1:10 AND TGSIs SHALL NOT BE APPLIED OVER THE 1:10 SECTION.
 - IF DIMENSION 'A' IS BETWEEN 1.9m AND 6m THEN MAXIMUM ALLOWABLE GRADE SHALL BE 1:14 AND ADDITIONAL TGSIs WILL BE REQUIRED AS PER AS1428.4.
 - IF DIMENSION 'A' IS BETWEEN 6m AND 14m THEN MAXIMUM ALLOWABLE GRADE SHALL BE 1:19 AND ADDITIONAL TGSIs WILL BE REQUIRED AS PER AS1428.4.
 - IF THE MAXIMUM GRADE CONSTRAINTS CANNOT BE MET DUE TO SITE CONSTRAINTS, AN INDIVIDUAL DETAILED DESIGN WILL BE REQUIRED.
- IF DIMENSION 'A' IS LESS THAN 500mm THEN THE BUS STOP SHALL BE IN ACCORDANCE WITH STD_S0064
- IF DIMENSION 'A' IS GREATER THAN 2.0m THEN CRACK CONTROL JOINTS SHALL BE PROVIDED IN ACCORDANCE WITH LOCAL COUNCIL SPECIFICATIONS. IF DIMENSION 'A' IS GREATER THAN 6m THEN EXPANSION JOINTS SHALL ALSO BE REQUIRED IN ACCORDANCE WITH LOCAL COUNCIL SPECIFICATIONS.
- IF DIMENSION 'A' IS OF A GRADE OF 1:20 ~ 1:33 THE DIRECTIONAL TGSIs SHOULD NOT BE APPLIED OVER IT. IF DIMENSION 'A' IS OF A GRADE OF 1:33 ~ 1:1000 THE DIRECTIONAL TGSIs SHOULD BE CONTINUOUS (AS SHOWN).
- ALL CONSTRUCTED CONCRETE FOOTPATHS SHALL BE BUILT TO LOCAL COUNCIL FOOTPATH STANDARDS. WHERE EXISTING FOOTPATH IS ASPHALT, MINIMUM PANEL WIDTH TO BE REPLACED WITH CONCRETE IS 1200mm.
- DRAWINGS STD_S0062 - STD_S0081 SHALL BE READ IN ASSOCIATION WITH EACH OTHER.
- IF GRADE 1:40 CAN NOT BE ACHIEVED ON LANDING, THE FOOTPATH SHALL NEED TO BE LOWERED/RAISED AND TRANSITION GRADE TO BE BETWEEN 1:14 AND 1:20 AS PER COUNCIL REQUIREMENT.
- ENSURE INVERT OF NEW KERB IS ALIGNED AND CONTINUES WITH EXISTING KERB
- EXPANSION JOINT IS REQUIRED IF HARDSTAND IS MORE THAN 6M LONG.

125mm THICK 25MPa REINFORCED CONCRETE SLAB WITH SL72 MESH PLACED CENTRALLY ON BAR CHAIRS AND 50mm THICK CLASS 2 COMPACTED CRUSHED ROCK BASE. CONCRETE SLAB TO HAVE A BROOM FINISH WITH NO HIGHLIGHTS AND BE DOWELLED INTO KERB AND FOOTPATH (PROVIDED EXISTING FOOTPATH DEPTH IS GREATER THAN 90mm). (REFER DRAWING STD_S0062 FOR DETAILS)

IF ANY STEP RESULTS FROM WORK BETWEEN NEW CONCRETE SLAB AND NATURAL NATURESTRIP LEVEL, SOIL AND SEED A BATTER AT MAXIMUM GRADE OF 1:6

JOINTS TO BE PROVIDED. REFER TO NOTE 6 FOR JOINT SPECIFICATION.

DIM 'A' 500MIN. (REFER NOTES 5 ~ 7)

STANDARD FLAG POLE SLEEVE TO SUIT 50NB POLE (REFER TO DRAWING STD_S0062)

9200 LENGTH BARRIER KERB TO BE MINIMUM OF 150mm IN ACCORDANCE WITH VICROADS STANDARD DRAWING SD2001. (REFER NOTE 2)

Certified By:

(DATE)

(SIGNATURE)

(BLOCK LETTERS)

23/04/19 12:00:00 PM

Revised By	In Serv	Rev.	Date	Description	Designed	Checked	Ind. Review	Approved
TOMKINSON		D	15/10/21	AMENDMENTS AS PER DOT COMMENTS	OB	JH	MM	MM
TOMKINSON		C	11/10/21	AMENDMENTS AS PER DOT COMMENTS	OB	JH	MM	MM
TOMKINSON		B	07/02/20	AS PER PTV COMMENTS	JG	JG	RQ	JG
TOMKINSON		A	20/01/20	AS SUBMITTED TO PTV	JG	JG	RQ	JG

Consultant	This drawing has been prepared by, or compiled from information provided by, persons other than PTV. To the maximum extent permissible by law, PTV takes no responsibility for, and makes no representations in relation to, the completeness, accuracy or quality of any information contained in this drawing. Each user of this drawing releases PTV from all and any loss, damage, cost, expense or liability in relation to the use of, or any reliance on, this drawing or the information contained in it.
Franchisee / Lessee	

All written dimensions take precedence over scaled dimensions.
This drawing is provided only for the information of the person or organisation to whom PTV provides it. It may not be provided to, or used by, any other person without PTV's prior written consent.

STANDARD DRAWING		
BUS STOP FOR A SITE WITH A NATURE STRIP BETWEEN FOOTPATH AND KERB GREATER THAN 2700mm		
Up Location	Down Location	Datum
East . . .	East . . .	
North . . .	North . . .	
ID# . . .	ID# . . .	

ORGANISATION	AUTHORISED BY	DATE
DOT		
File Name	STD_S0065_REVA.DWG	
Sheet No.	1 of 1	
In Serv.		
Scale	1:25	
Sheet Size	A3	

Drawn By	OB	Designed By	OB
Checked By	JH	Ind. Review	MM
Approved	MM	Approval Date	15/10/21
Drawing Number	STD_S0065	Revision	D