

PLAN

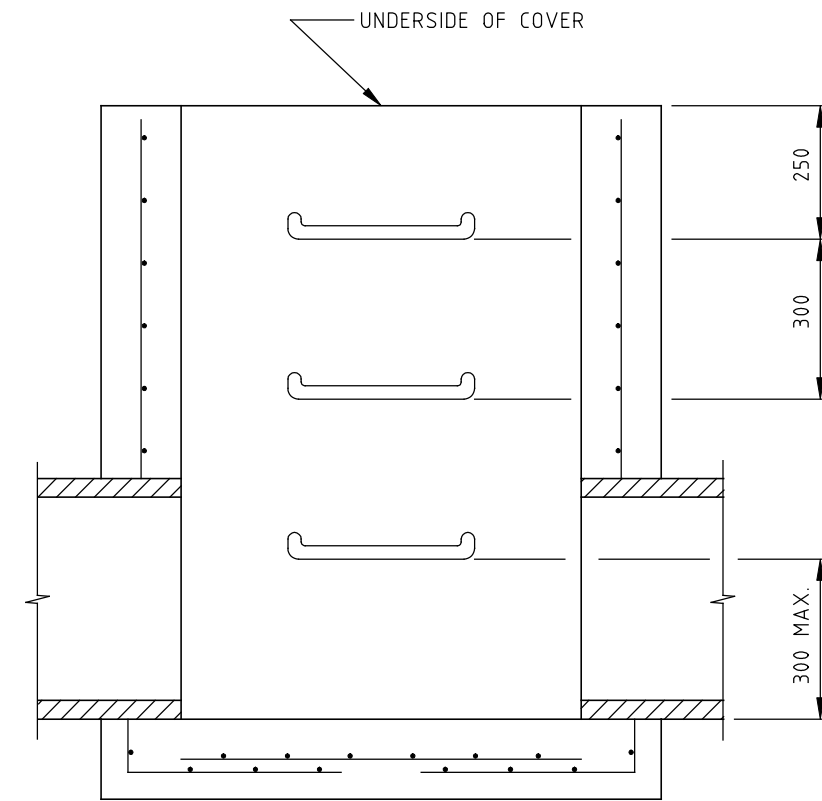

SECTION A-A

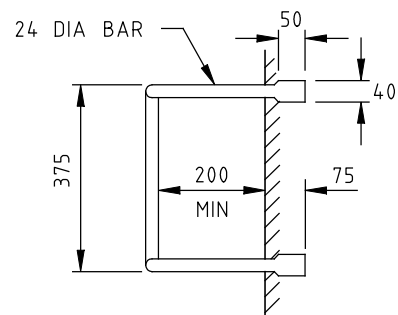
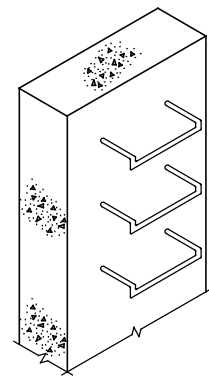
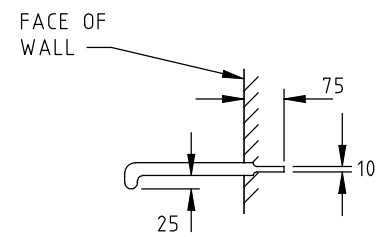

STEP IRON DETAILS

NOTES:

1. PITS DEEPER THAN 1000 SHALL BE FITTED WITH STEP IRONS.
2. STEP IRONS SHALL BE LOCATED:
 - DIRECTLY BELOW THE OPENING IN THE COVER.
 - DESIRABLY ON A WALL WITHOUT PIPE OPENINGS.
 - DESIRABLY ON ONE OF THE LONG SIDES OF THE PIT.
3. STEEL FOR STEP-IRONS SHALL BE STRUCTURAL GRADE 250 TO AS3679 PART 1.
4. STEP IRONS SHALL HAVE SHARP EDGES ROUNDED AND HOT DIP GALVANIZED AFTER FABRICATION TO AS/NZS 4680
5. PROPRIETARY STEPS SUCH AS THE GATIC 373 PM POLYPROPYLENE STEPS (OR APPROVED ALTERNATIVE) MAY BE USED. THESE SHALL BE INSTALLED ACCORDING TO THE MANUFACTURERS INSTRUCTIONS.
6. FOR PRECAST PITS, STEP IRONS SHALL BE LOAD TESTED TO AS4198/1994.

sd-1041c.dgn 12:07:52 PM 30/03/2006

ISSUE	APP'D	DATE	AMENDMENT
E			
D			
C	J . K	1/7/05	NOTE 3 AMENDED
B	J . B	1/8/02	IRON STEP HEIGHT NOW 375. ALSO NOTE 4 & 5 AMENDED.
A	J . C	SEPT94	AMENDMENTS TO NOTES 3, 4 & 6, GENERAL NOTE 3.

GENERAL NOTES
 1. UNHAUNCHED PITS
 2. HAUNCHED PITS
 3. ALL DIMENSIONS ARE IN MILLIMETRES

SD 1011
SD 1021

DESIGNED PRINCIPAL ROAD
DESIGN ENGINEER

APPROVED 16.9.94
J. Cunningham

CATALOG PRED
PROJECT sddgnnew
FILENAME sd-1041b.dgn



3 PROSPECT HILL ROAD,
CAMBERWELL,
VICTORIA, 3124
PHONE NO. (03) 9811 8355
FAX NO. (03) 9811 8329

SCALE HOR NOT TO SCALE
OF METRES VER

STANDARD DRAWING
STEP IRONS

FILE NO.	CONTRACT NO.	SHEET NO.	DRAWING NO. SD 1041	ISSUE C
----------	--------------	-----------	------------------------	------------