

ISSUE	APPROVED BY	DATE	AMENDMENT

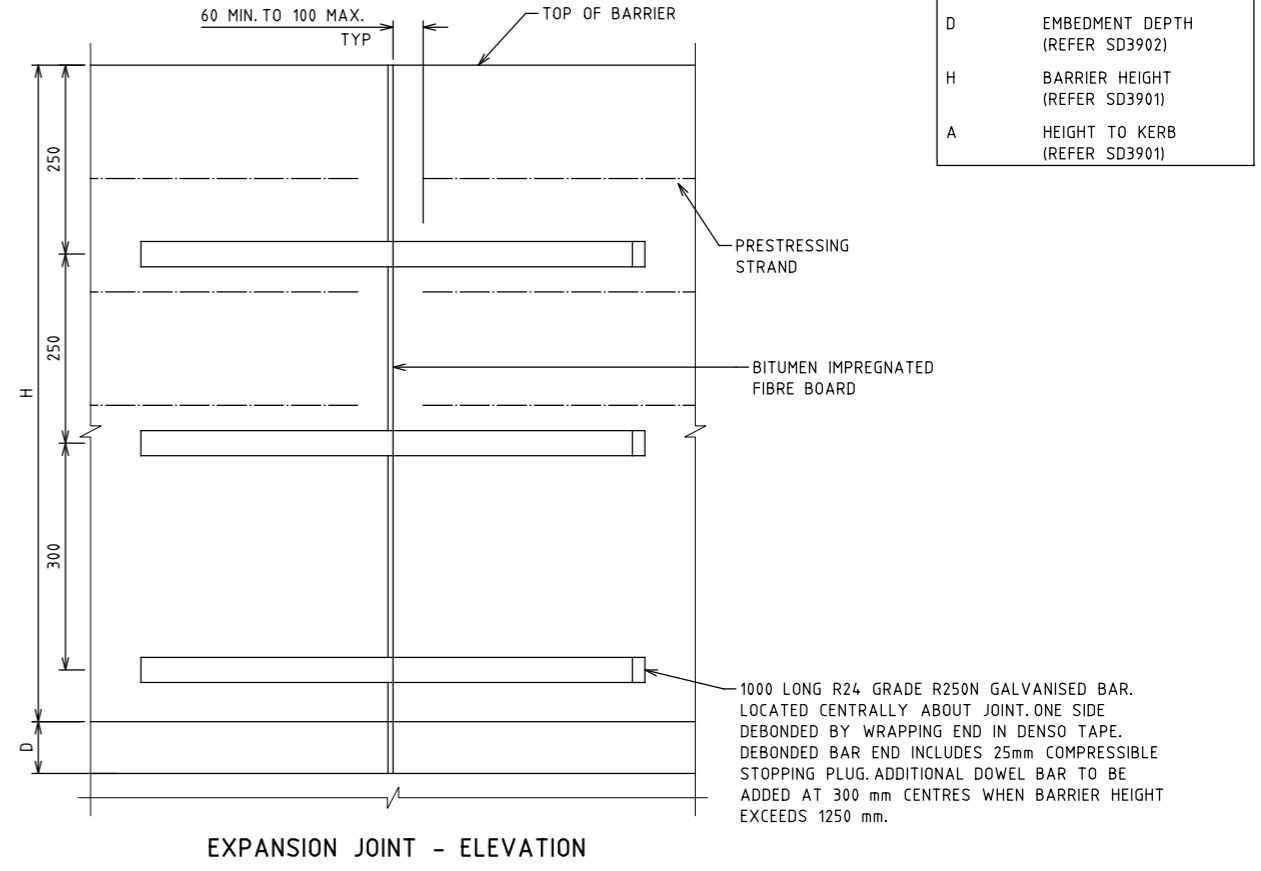
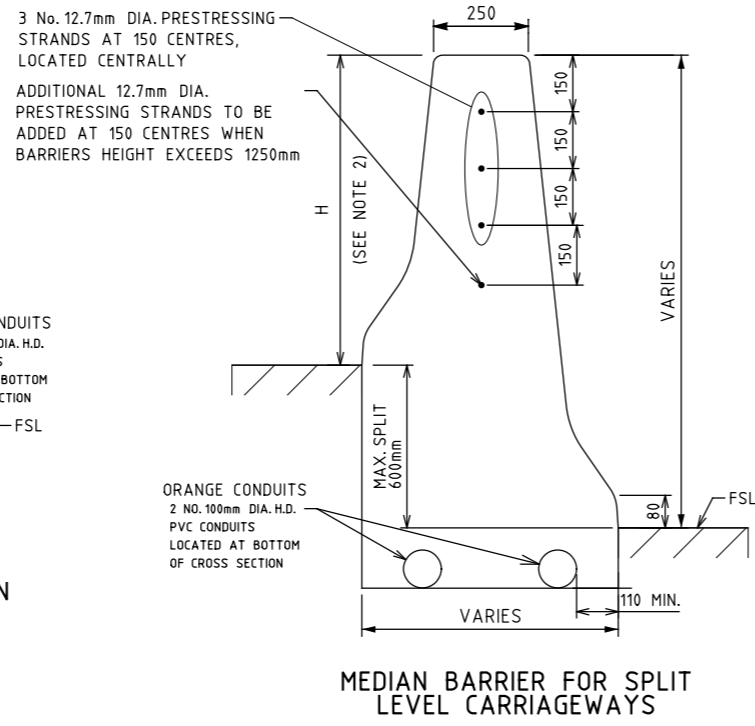
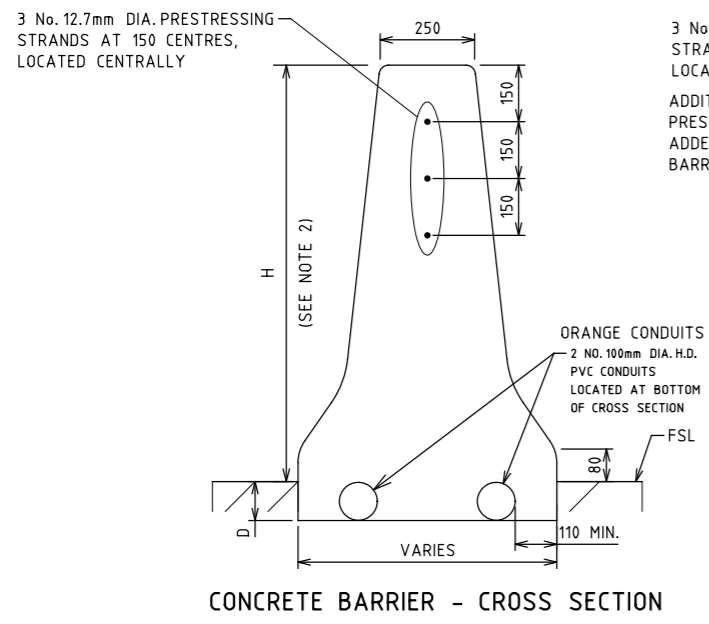

FSL	FINISHED SURFACE LEVEL
D	EMBEDMENT DEPTH (REFER SD3902)
H	BARRIER HEIGHT (REFER SD3901)
A	HEIGHT TO KERB (REFER SD3901)

NOTES

- PROFILE AND INSTALLATION:
- CONCRETE BARRIER PROFILE TO BE IN ACCORDANCE WITH SD3901. CONCRETE BARRIERS SHALL BE ADEQUATELY CONSTRUCTED IN ACCORDANCE WITH SD3902, SD3906 AND SD3907 AS SPECIFIC TO SLIP FORM CONCRETE BARRIERS.
 - THE MAXIMUM BARRIER HEIGHT SHALL NOT EXCEED 1250mm WITHOUT ADDITIONAL PRESTRESSING STRANDS INSTALLED AT 150 CENTRES. SPLIT LEVEL BARRIERS SHALL BE IN ACCORDANCE WITH SD3901.
- CONSTRUCTION:
- CONSTRUCTION SHALL COMPLY WITH SECTION 716 OF VICROADS STANDARD SPECIFICATION.
 - F-SHAPE CONSTRUCTION REQUIRES A SITE-SPECIFIC DESIGN AND APPROVAL, CONSIDERING ALL SHAPE (SD3901) AND INSTALLATION (SD3902 OR SD3906 AS APPROPRIATE FOR SLIP FORMED BARRIERS) REQUIREMENTS.
 - ANY CUT-OUTS, BLOCK-OUTS, ADDITIONAL REINFORCEMENT OR ANY OTHER MODIFICATION TO THE BARRIER PROFILE SHALL NOT BE PERMITTED WITHOUT APPROVAL FROM THE SUPERINTENDENT.
 - ALL CONDUITS SHALL HAVE DRAW CORDS IN ACCORDANCE WITH SECTION 733 OF VICROADS STANDARD SPECIFICATION TO FACILITATE INSTALLATION OF FUTURE CABLES.
- CONCRETE:
- CONCRETE SHALL BE VR330/32 IN ACCORDANCE WITH SECTION 610 OF VICROADS STANDARD SPECIFICATION.
 - CONCRETE SHALL BE IMPREGNATED WITH 50mm VIRGIN POLYPROPYLENE FIBRILLATED FIBRES AT THE RATE OF 0.9kg/m³ IN ACCORDANCE WITH SECTION 716 OF VICROADS STANDARD SPECIFICATION.
 - EXPOSURE CLASSIFICATION SHALL BE B1 MINIMUM AS DEFINED IN AS 5100 PART 5.
 - THE TOLERANCES FOR CONSTRUCTION SHALL BE TO AS3845.1: TABLE 5.7.5 FOR SLIP FORMED CONSTRUCTION AND THE REQUIREMENTS IN VICROADS SPECIFICATION 716.
 - SURFACE FINISH SHALL BE CLASS 2 IN ACCORDANCE WITH SECTION 610 OF VICROADS STANDARD SPECIFICATION.
- REINFORCEMENT:
- THE REINFORCEMENT SHALL BE 3 No. PRESTRESSING STRAND 7-WIRE ORDINARY 12.7mm 1870-RELAX 2 STRANDS TO AS 4671.1. THE REINFORCEMENT SHALL EXTEND THE FULL DISTANCE BETWEEN EXPANSION JOINTS. WELDING SHALL NOT BE PERMITTED.
 - COVER 60mm TO 100mm AT EXPANSION JOINTS.
 - REINFORCING STRAND TO BE LAPPED AS PER STANDARD SECTION 716 SLIP FORMED BARRIERS.
 - ALL REINFORCEMENT AND STRAND TO BE LOCATED CENTRALLY IN A VERTICAL PLANE BELOW THE TOP FACE OF THE BARRIER, INCLUDING FOR SPLIT LEVEL BARRIERS.
- EXPANSION JOINTS:
- THE MAXIMUM LENGTH OF BARRIER BETWEEN EXPANSION JOINTS SHALL BE THE LESSER OF:
 - THE LENGTH OF ONE DAYS POUR; OR
 - 150m
 - EXPANSION JOINTS SHALL BE SQUARE TO THE BARRIER CENTRELINE. THE JOINT SHALL HAVE 25mm THICK BITUMEN IMPREGNATED FIBREBOARD OR OTHER FLEXIBLE JOINT FILLER BETWEEN THE BARRIER SECTIONS.
 - 3 No. 24mm DIA GRADE R250N GALVANISED DOWEL BARS 1.0M LONG CENTRALLY LOCATED ABOUT THE JOINT WITH ONE SIDE DE-BONDED BY WRAPPING WITH DENSO TAPE WITH A 25mm EXPANSION PLUG AT THE END OF EACH DOWEL.
- CONTRACTION JOINTS:
- CONTRACTION JOINTS SHALL BE FORMED BY SAW CUTTING 65mm INTO THE FACE OF THE BARRIER.
 - CONTRACTION JOINTS ARE TO BE CUT AT A MAXIMUM OF 3.0m CENTRES.
 - CONTRACTION JOINTS TO BE SAW CUT WITHIN THE TIMEFRAMES NOMINATED IN SECTION 716 OF VICROADS STANDARD SPECIFICATION

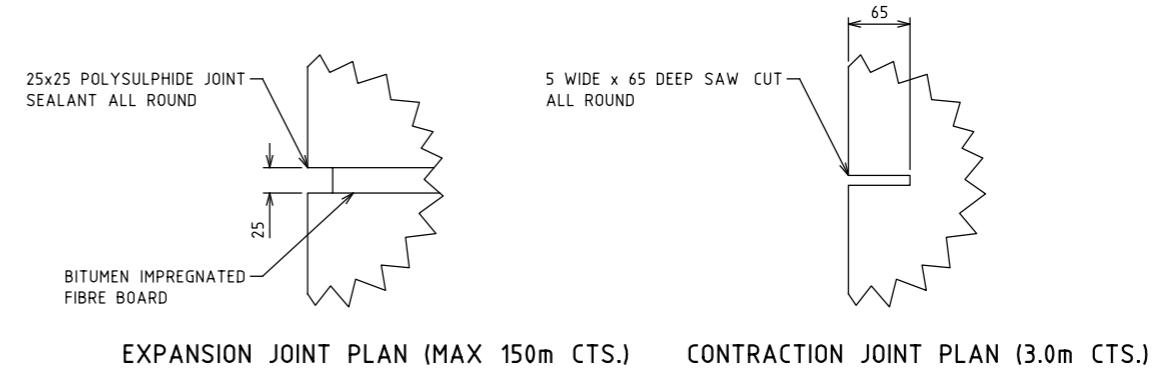

REFERENCES AND NOTES:
1. ALL DIMENSIONS ARE IN MILLIMETRES UNLESS SHOWN OTHERWISE.

DISCLAIMER
THIS DRAWING DOES NOT COVER PERFORMANCE LEVEL BARRIERS WHICH SHALL BE DESIGNED TO FULLY COMPLY WITH THE REQUIREMENTS OF AS5100 IRRESPECTIVE OF THIS DRAWING

ROAD AND TRAFFIC DESIGN
MANAGER SAFE SYSTEM ENGINEERING
60 DENMARK STREET KEW VICTORIA 3101 PHONE (03) 9854 2666



ROAD SAFETY BARRIERS			
SLIP FORM CONCRETE BARRIER			
F-SHAPE INSTALLATION AND CONSTRUCTION			
NOT TO SCALE	APPROVED M-RD&SSE	12/2021	SD NO. SD3906
			ISSUE

VicRoads Drawing No. 720376